

NOTES:

1. Read notes on all sheets together with specifications and notify engineer of any discrepancies.
2. All dimension in millimeters unless specified otherwise.
3. All pre-cast elements to the manufacturers specifications.
4. Use liquid mix of Sika 212 grout (5mm thick 500sq on site concrete over pole positions, if piled) to level seat for U-Culverts

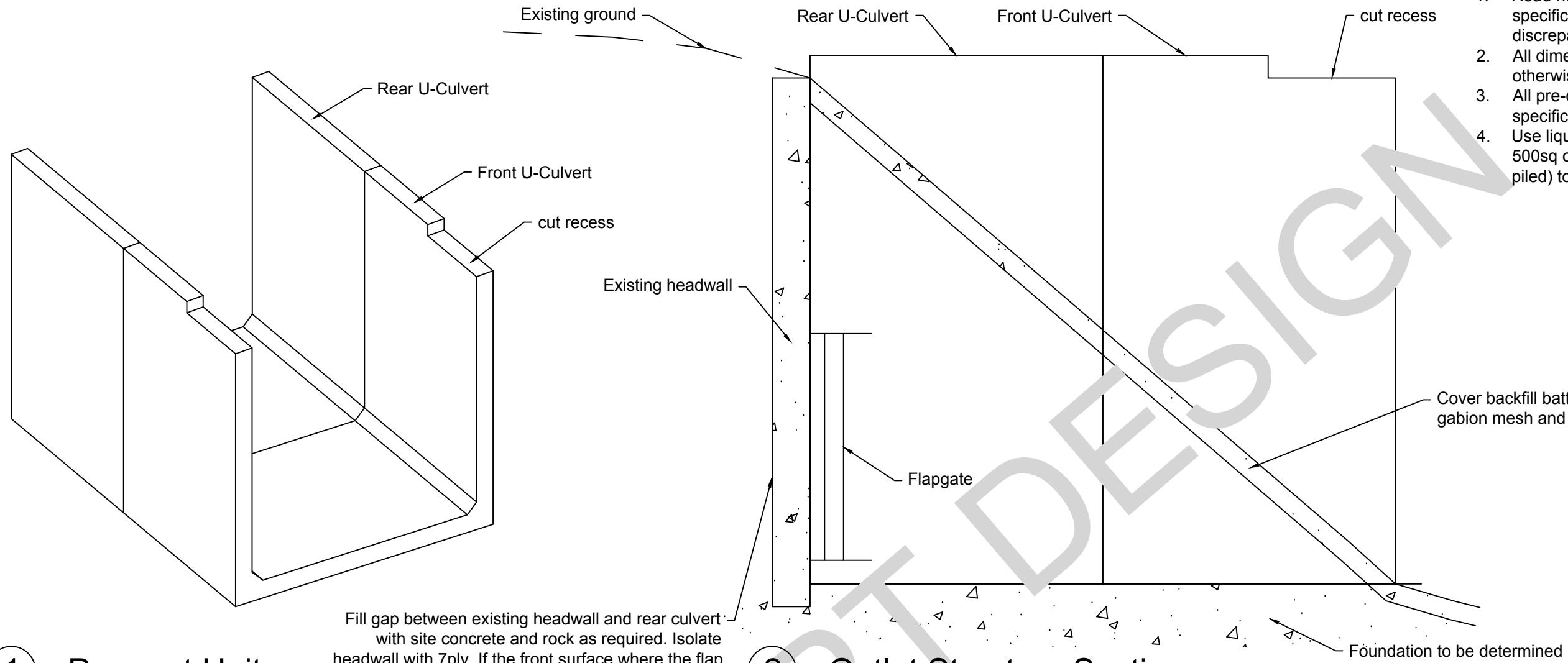

Fill gap between existing headwall and rear culvert with site concrete and rock as required. Isolate headwall with 7ply. If the front surface where the flap engages is not smooth it can be cleaned by water blasting and plastering using Sika Emulsion 923N.

1 Pre-cast Units

2 Outlet Structure Section

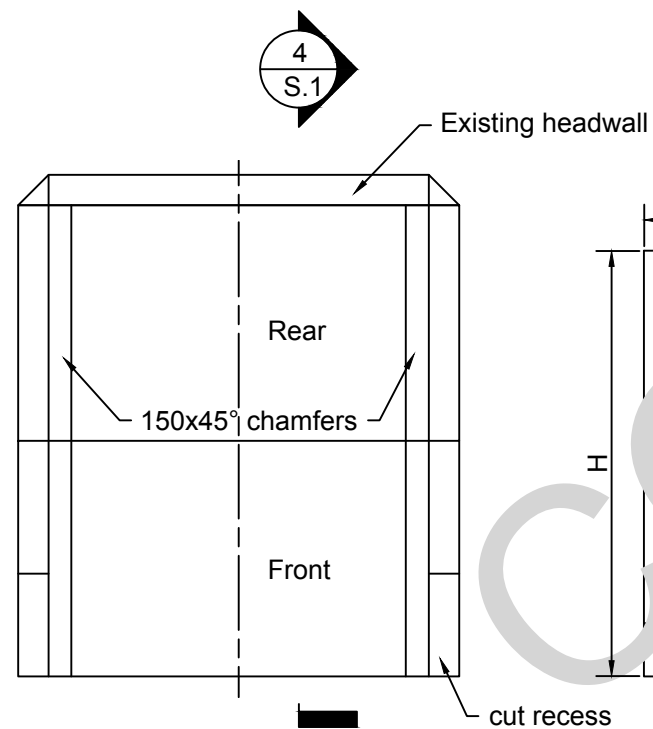

3 Plan View

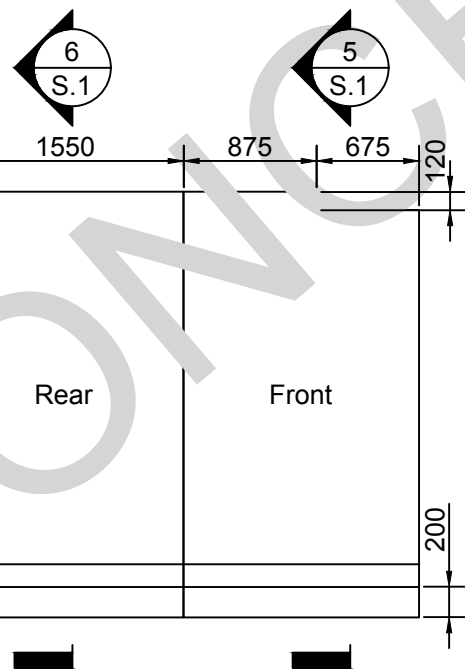

4 Section

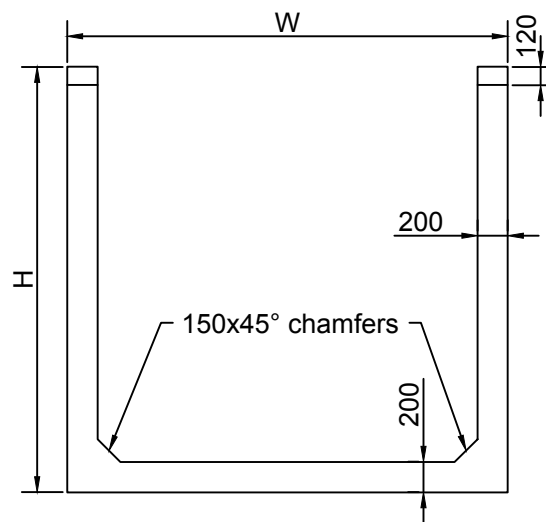

5 Front U-Culvert

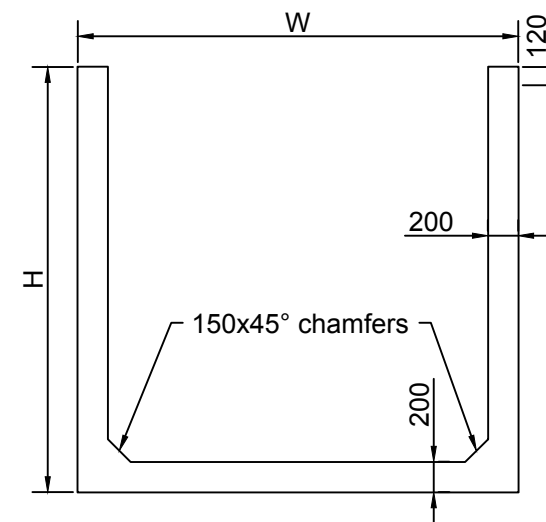

6 Rear U-Culvert

0	Construction Issue	A Morphet	29/11/19
Rev	Description	Approved	Date



Concept Design

Outlet Structure

Date: 29 November 2019	Drawn: A McCaughan
	Checked: M Farrell

Drawing Number WRC-1696	REV 0
----------------------------	----------

Scale: As indicated	@ A3
------------------------	------